

996-DS



Product features

Designed for applications where a constant outlet pressure is required over a wide range of inlet pressure.

- **First stage:** Reduces cylinder pressure by almost 90%.
- **Second stage:** The Ø70mm diaphragm in the second stage provides precise control over the outlet flow.
- **Applications:** Ideal for quality cutting, laboratory systems, precision machine cutting, rough machine cutting, hand cutting and chiseling.
- **Materials:** Equipped with a robust and corrosion-resistant stainless membrane for long life and reliability in demanding environments.
- **Durable construction:** Engineered to withstand harsh industrial conditions, minimizing maintenance and downtime.

Technical data

Type	2-stage
Regulator class	1
Standard	ISO 2503
Gas	Ar/mix / Nitrogen/ Oxygen
Temperature range	-20°C up to +60°C

Pressure / Flow

Inlet pressure P ₁	200/ 300 bar
Outlet pressure P ₂	0-10 bar
Q _n	150m ³ /h

Materials:

Valve body	CW 617N/ CW 614N
Valve seat	Kel-F
Diaphragm	Stainless steel, AISI302
Valve cap	Chrome-plated zinc

Connections:

Inlet	See page 2
Outlet	See page 2

Flowchart

10 bar compressed gas

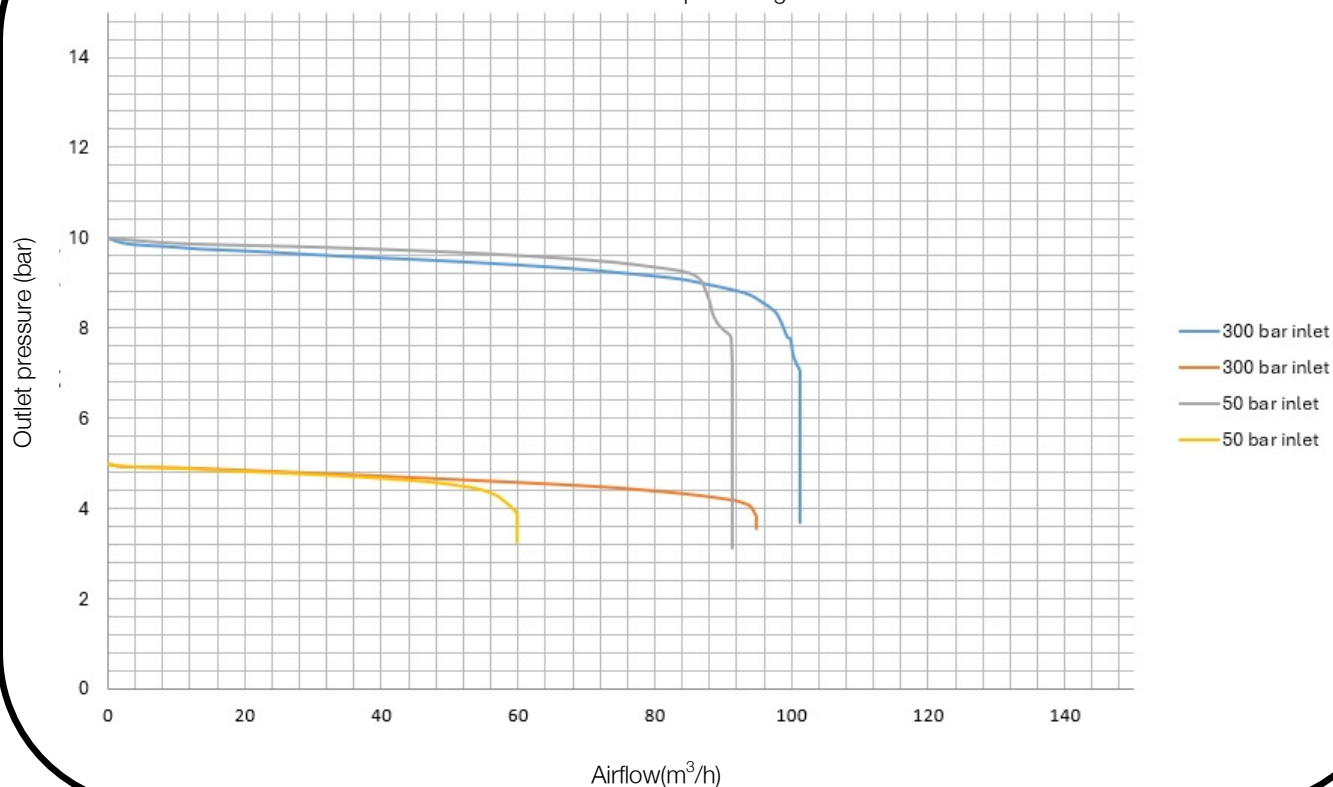

Dimensions

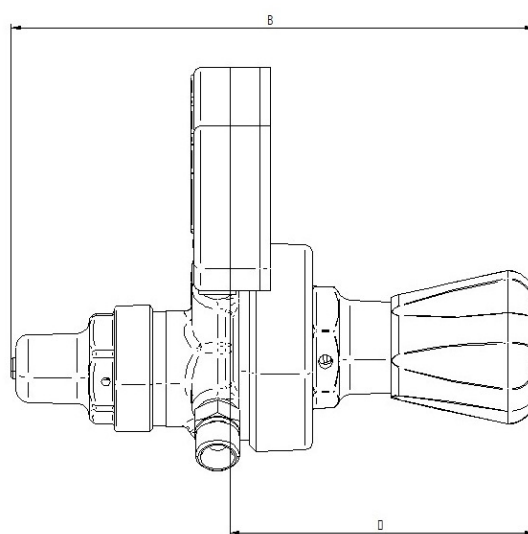
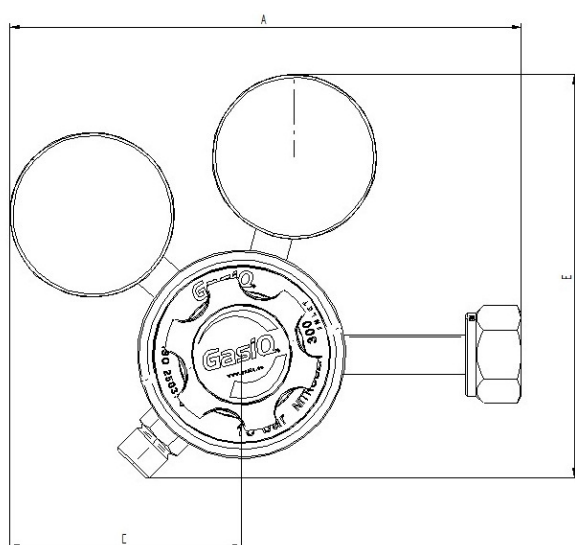

Inlet	Outlet	A	B	C	D	E
W24.32x1/4" NPT	G3/8"	193mm	197mm	87mm	115mm	152mm
W21.8x1/4" NPT	G3/8"	193mm	197mm	87mm	115mm	152mm
G5/8" Bullnose NPT	G3/8"	208mm	197mm	87mm	115mm	152mm